

Lotus[®] Plus

Passive Self-Ligating
Bracket System





Lotus[®] Plus

Passive Self-Ligating Bracket System

Designed by an Orthodontist for Total Control and Maximum Patient Comfort

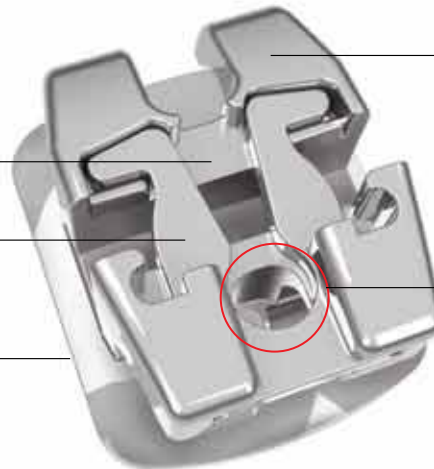

Open Design
Allows for maximum patient hygiene

Unique Clip Design
Allows for easy opening and secure closure of the clip

80 Gauge Foil Mesh Base
Ensures maximum bond strength

Ultra Low Profile
For a more aesthetic appearance
Maximum patient comfort and satisfaction
Avoids occlusal and incisal interference

Identification System
By quadrant with removable color coded dot and permanently by a raised I.D. mark

Easy Opening Clip
Opens easily with an explorer



Contoured Tie-Wing
For added patient comfort

Generous and Defined Tie-Wing Undercuts
Ensures easier and more secure ligation if needed

Compound Contour Base
Provides simplified and accurate bracket placement

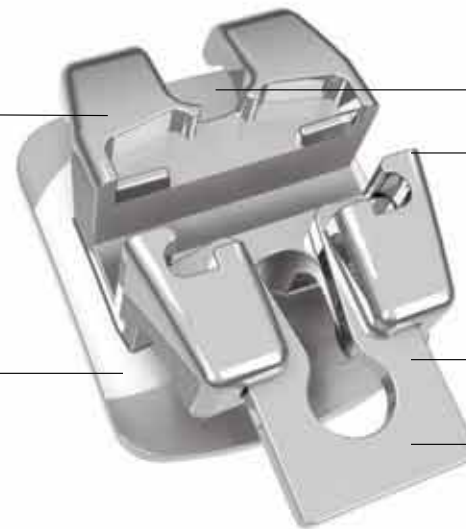

Vertical Channel
For bracket positioning

Mini-Twin Design
With rhomboid shape for easy placement

Convertible Clip
Removable clip allows for ligature ties during finishing phase if desired

High Quality Thermal Nickel Titanium
For flexibility and long-life

Lotus® Plus Gives You The Control You Have Been Looking For!



Easy Opening

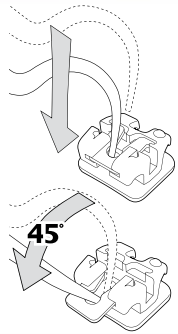

The Lotus Plus bracket opens easily and requires no special tools

Simply insert the end of an explorer into the circular opening located just below the archwire slot.

Rotate the explorer in a downward 45° motion, gently easing the clip open. Do not pull down on the clip as this will convert the bracket. The clip will audibly “click” once as it disengages from the top lock and “click” a second time when fully opened.

Secure Closure

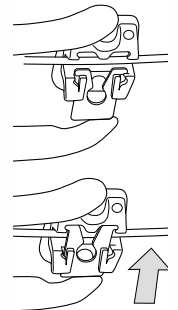

Using a utility plier or tweezers place one open instrument tip on the top of the bracket and the other open tip at the bottom of the open clip.

Gently apply pressure to the plier or tweezers and the clip will begin to move up. The clip will audibly “click” once as it disengages from the bottom lock and “click” a second time when closed.

Finish with Control



Convertible Bracket

If you wish, during the finishing phase, clips can easily be removed and ligatures can secure the archwire into the slot.

To Convert The Bracket

Pull the clip down to remove, when you desire to disengage the clip and convert the bracket.

Lotus® Plus Bracket System Starter Kits

Starter Kits Contains Everything You Need for the Treatment of Eight Patients

Each Lotus Plus Starter Kit Includes

- 8 Lotus .022" Slot Single Patient Kits (160 Brackets)
- Stackable Organizer
- Lotus SLB Ligature Director & Explorer Clip Opening Tool - Hook Style
- Lotus SLB Bracket Tweezers Clip Closing Tool - Tweezer Style
- TruFlex™ Thermal Nickel Titanium Archwires
.013" (10/pk) .014" x .025" (10/pk)
.014" (10/pk) .018" x .025" (10/pk)
- TruForce™ Stainless Steel Archwires
.019" x .025" (10/pk)
- BetaForce™ Beta Titanium Archwires
.019" x .025" (10/pk)
- Crimpable Ball Hooks 3.3mm (20/pkg)
- Crimpable Mini Stops - Large (50/pkg)
- Crimpable Mini Stops - Small (50/pkg)

Lotus Plus

Roth® Prescription® Starter Kits

Description	Item Numbers
5x5 No Hooks	700005
5x5 Hooks on 3's	700006
5x5 Hooks on 3, 4, & 5's	700007

Lotus Plus McLaughlin, Bennett, & Trevisi Prescription® Starter Kits

Description	Item Numbers
5x5 No Hooks	300005
5x5 Hooks on 3's	300006
5x5 Hooks on 3, 4, & 5's	300007

Lotus Plus Damon® Standard Torque Prescription® Starter Kits

Description	Item Numbers
5x5 No Hooks	200005
5x5 Hooks on 3's	200006
5x5 Hooks on 3, 4, & 5's	200007



Lotus® Plus Typodont

Bonded 5x5 with Lotus® Plus brackets, buccal tubes and stainless steel archwires
Item #: G50-622



Lotus® Plus Single Patient Kits

Ortho Technology's versions of the

Damon® Standard Torque Prescription*

Patient Kits	Item Numbers
Description	.022" Slot
Upper/Lower 5x5 No Hooks.....	6322-1000
Upper/Lower 5x5 Hooks on Cuspids	6322-1300
Upper/Lower 5x5 Hooks on 3, 4, & 5	6322-1345

Damon® Low Torque Prescription*

Patient Kits	Item Numbers
Description	.022" Slot
Upper/Lower 5x5 No Hooks.....	6422-1000
Upper/Lower 5x5 Hooks on Cuspids	6422-1300
Upper/Lower 5x5 Hooks on 3, 4, & 5	6422-1345

Damon® Super Torque Prescription*

Patient Kits	Item Numbers
Description	.022" Slot
Upper/Lower 5x5 No Hooks.....	6522-1000
Upper/Lower 5x5 Hooks on Cuspids	6522-1300
Upper/Lower 5x5 Hooks on 3, 4, & 5	6522-1345

Roth Prescription*

Patient Kits	Item Numbers
Description	.022" Slot
Upper/Lower 5x5 No Hooks.....	7322-1000
Upper/Lower 5x5 Hooks on Cuspids	7322-1300
Upper/Lower 5x5 Hooks on 3, 4, & 5	7322-1345

McLaughlin, Bennett, & Trevisi Prescription*

Patient Kits	Item Numbers
Description	.022" Slot
Upper/Lower 5x5 No Hooks.....	5322-1000
Upper/Lower 5x5 Hooks on Cuspids.....	5322-1300
Upper/Lower 5x5 Hooks on 3, 4, & 5	5322-1345

Replacement Clips are also Available



Lotus® Plus Combines Traditional Twin Bracket Treatment With Self-Ligation Convenience

Designed by an Orthodontist

The initial concept for the Lotus Plus Self-Ligating Bracket System started with a simple set of goals. First, design a bracket system that will deliver maximum patient comfort and hygiene. Second, design a system that would be familiar to orthodontists around the world. Third, the bracket must have a reliable and simple to use self-ligating clip made from advanced material. Last and most important, the system must allow the doctor to be able to finish the case with total control.

Maximum Patient Comfort and Hygiene

The advanced ergonomic design of Lotus Plus Self-Ligating Bracket System provides superior patient comfort and allows for unrestricted access for optimal dental hygiene. Other self-ligating systems with closed cavities or geometric frames make access harder and may lead to the accumulation of plaque. Additional plaque concerns associated with elastomeric ligatures are also eliminated.¹

Familiar Twin Design

The familiar twin design with a rhomboid shape and level slot alignment of the Lotus Plus Self-Ligating Bracket System allows for fast and accurate bracket placement. Although the Lotus Plus is a self-ligating bracket



it still has generous under tie-wing area for easy engagement of elastomeric power chain or ligature ties if desired. Each Lotus Plus bracket has the ideal inter-bracket distance and built-in torque-in-base to provide the highly effective rotational and torque control needed during treatment.

Thermal Nickel Titanium Clip

Archwire changes with Self-Ligating Bracket Systems are fast and economical when compared to conventional brackets.² The Lotus Plus Self-Ligating Bracket System features a unique convertible clip that is made of extremely wear resistant, high quality nickel titanium for flexibility and long-life during the entire length of treatment. The passive design of the Lotus Plus Clip provides optimal sliding mechanics; friction is eliminated when using light wires allowing for extremely fast and effective tooth movement.

Finish with Total Control

During treatment it's sometimes desirable to tie or anchor the tooth or group of teeth to prevent unwanted movement along the archwire; the Lotus Plus Self-Ligating Bracket System delivers this functionality where other systems don't. Lotus Plus Brackets can be converted anytime during treatment by removing the clip. Lotus allows for easy ligation of archwires with metal or elastomeric ligatures. Ligatures can be used during the finishing and detailing phases. The Lotus Plus Self-Ligating Bracket System gives you the total control you need to finish the case.

Lotus[®] Plus

Passive Self-Ligating Bracket System

Suggested Order, Duration, and Objective of Basic Archwire Sequence

Phase I	Round Archwires	Duration	Objective
.013" or .014"	TruFlex™ Thermal Nickel Titanium Universal Form .013" Item #: 2001-101 .014" Item #: 2001-102	10 Weeks	Cases with severe crowding
.018"	TruFlex™ Thermal Nickel Titanium Universal Form Item #: 2001-104	10 Weeks	Level and align Begin arch development Solve 90% of rotations
Phase II	Rectangular Archwires		
.014" x .025"	TruFlex™ Thermal Nickel Titanium Universal Form Item #: 2001-114	10-20 Weeks	Complete leveling and alignment Resolve remaining rotations Start control of torque Consolidation of the anterior spaces Continue arch development without expanders or quad-helix
.018" x .025"	TruFlex™ Thermal Nickel Titanium Universal Form Item #: 2001-118	4-6 Weeks	Fine tune torque control Continued development of the arch
Phase III	Mechanics at Work		
.019" x .025"	TruForce™ Stainless Steel Universal Form Item #: 2003-119	20-30 Weeks	Finish torque control Consolidation of posterior spaces Adjustments to buccal, lingual, anterior, and posterior Coordination of the arch form
Phase IV	Finishing		
.019" x .025"	TruForce™ Stainless Steel Universal Form Item #: 2003-119 - or - .019" x .025" BetaForce™ Beta Titanium Universal Form Item #: 2002-119	10 Weeks	Specific detailing of patient arch form

Above chart is suggested order, duration, and objective of basic archwire sequence and by no means a replacement for professional expertise.



Universal Form™ Archwire

No technique can be considered complete without a system of high-quality archwires to optimize movement forces, with biologic respect for supporting structures.

The archwire sequence with the self-ligating bracket is slightly different, mainly due to the excellent control between bracket and archwire. It is very important to allow the archwire to complete its work. Therefore, an 8-10 week interval between appointments is recommended.

The initial phase uses round thermal archwires for movement, rotation control, leveling, alignment, and initial arch development. For patients with severe crowding, it may be necessary to continue with the same initial archwire for more than one appointment, prioritizing the use of light forces and allowing the archwire enough time to execute all of its leveling potential.

During the second phase, rectangular archwires with thermal activation will be utilized. This phase is considered fundamental for development and treatment success. The second phase encompasses the conclusion of leveling, rotation control, arch development continuation, torque initial-ization, root control, and space consolidation for anterior segments.

The mechanical phase will focus on closure of posterior spaces, coordination of the arches, and adjustment and correction of tooth positioning.

When it is time for finishing touches and individualization of each case, torque and adjustment needs will be minimal. If torque and small adjustments are needed, the preferred archwire should be the BetaForce archwire.

Tel 0117 975 5533 | Fax 0117 975 5575

Email info@tocdental.com | Web www.tocdental.com

The Old Church Collins Street Avonmouth Bristol BS11 9JJ